



LOCK-PLUG



PLUG-SOS

# LOCK PLUG INSTRUCTION MANUAL

PATENTED

## A : How to install Lock-Plug

cut off the latch

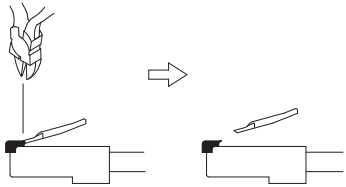

1

fix with Lock-Plug

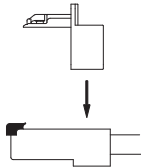

2

completed

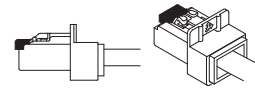

3

## B : How to secure Lock-Plug into port

put into jack directly

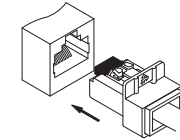

1

done

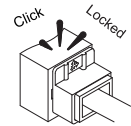

2

## C : How to release Lock-Plug

push the key to bottom



pull out the plug & key together !



release the key

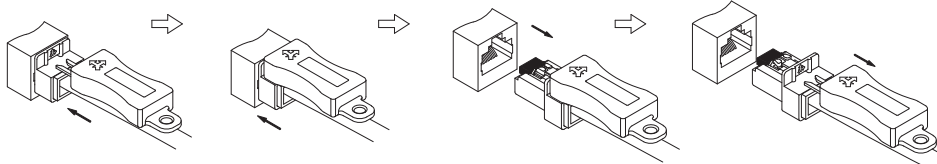

## D : How to exchange Lock-Plug & Plug-SOS

for regular function

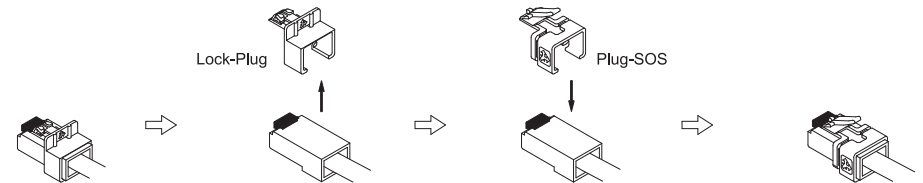

PLUG-SOS

## ⚠ WARNING

proper length

too short / long

skewed

always check for proper fixing of the latch or it can cause jam in the jack !

always to remove the key from Lock Plug to avoid clip part elastic fatigue

if clip part elastic fatigue, bend the clip outward

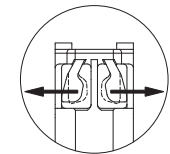
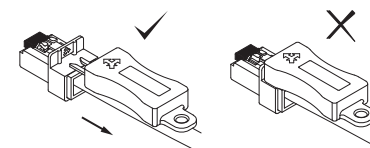
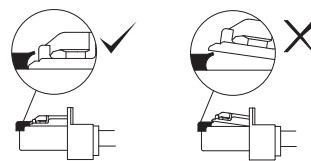
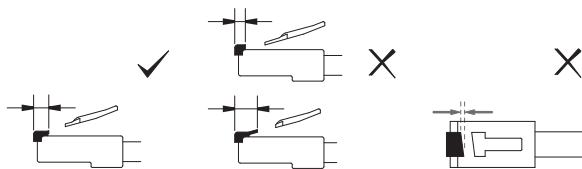

trim away any part of boot or Lock Plug to get the best matching

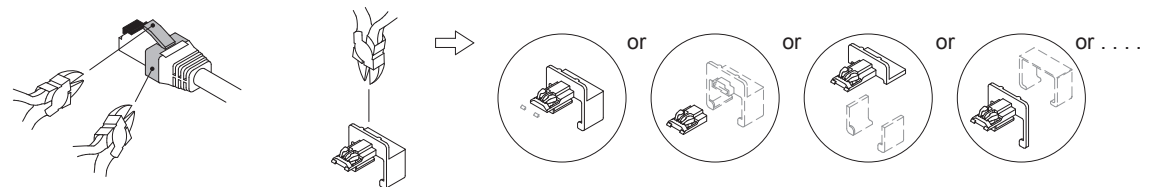

if high density jack does not clip, use thumb to push black area to lock

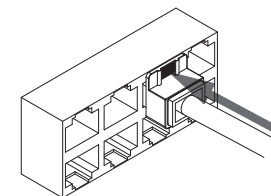

may not be suitable for some top opened, too high, or special jacks

